

DORMA: TENSOR DOUBLE ACTING GLASS HINGE

Glass preparation

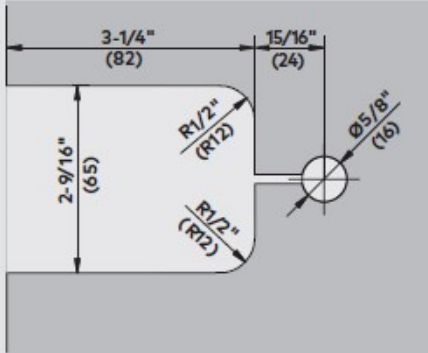

Drilling scheme

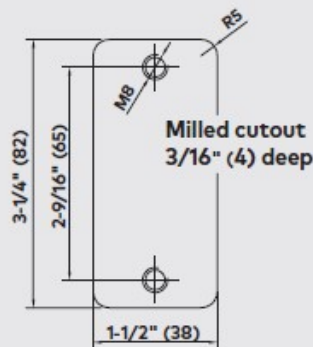

Please note:

- Substructure must be adequate for mounting the TENSOR hinges and tempered glass door.
- Excessive opening of the door must be prevented (max. 90°). Please use a door stop – see page 8.

TENSOR Double-acting hinges

Pair of double-acting hinges incl. mounting plate; for installation into frame with embedded mounting plate

For 3/8" (10) and 1/2" (12) glass

Finishes

Anodized aluminum EV1 (114)
Similar to satin stainless steel anodized (113)

